

# CONFERENCE CENTER & GRAND BALLROOM

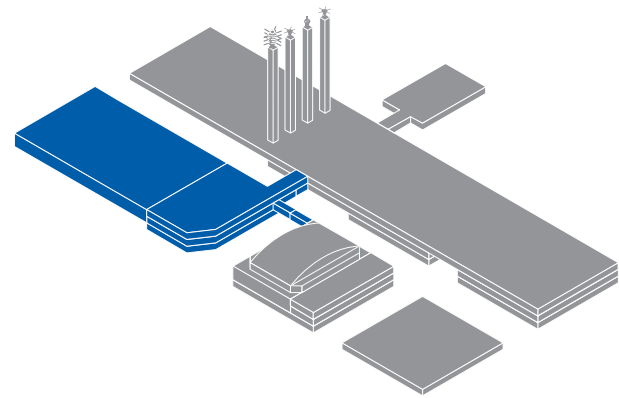

The complex's 100+ WiFi access points ensure you are always connected.

The versatile Conference Center complements your function and meeting space options when holding a meeting at the Exhibit Hall or serves as the perfect stand-alone facility for smaller conferences, meetings and special events. The architectural elements of the Conference Center provide a visual link between Bartle Hall and the beautiful Art Deco style of Kansas City's historic Municipal Auditorium. The 40,500-square-foot Grand Ballroom is expandable to **46,484 square feet** for events up to 4,000 people. Its unique interior design celebrates the city's fountains and features a controllable natural lighting system and a glass wall offering dramatic views to the south.

**NOTES:**

---



---



---

## CONFERENCE CENTER

- More than 56,000 total square feet on three levels, seating up to 6,000.
- Space is divisible to up to 19 rooms featuring high-speed Internet connectivity, sound-proof dividing walls, state-of-the-art sound system, variable lighting, individual temperature controls and centralized taping capabilities.
- Features 34,760 square feet of elegant registration or pre-function space that is divisible for up to three offices or breakout rooms to support registration area.
- Barrier free movement with conveniently located escalators, passenger and freight elevators.

## GREAT HALL (3501)

- Features 23,910 square feet, 28-foot ceilings and is divisible into eight breakout rooms.
- Comfortably seats 2,250 for general session and 1,650 for banquets.
- Connects via skywalks directly to the exhibit floor level of Bartle Hall and Municipal Auditorium.



## GRAND BALLROOM (2501)

- One of the nation's largest eco-friendly ballrooms at 46,484 square feet.
- Features dramatic views to the south of the Performing Arts Center via a 38-foot-high glass wall.
- Divisible into three separate rooms that can be operated independently for greater meeting flexibility.
- Offers a unique, controllable day-lighting system to allow natural light in the space that changes as the sun moves.
- Opens to an outdoor plaza at the southeast corner of the Convention Center complex.
- Connects to the existing Conference Center to accommodate additional breakout rooms.
- Connects to the new Loews hotel via enclosed walkway.

ROOM NAME	ROOM DIMENSIONS				ROOM CAPACITIES		
	SQ. FEET	WIDTH	LENGTH	CEILING	THEATER	CLASSROOM	BANQUET
<b>LEVEL 1</b>							
1501 A,B,C columns	14,904	72'	207'	18'	1,708	1,049	1,140
1501 A	3,752	67'	56'	18'	416	269	280
1501 B	7,238	77'	94'	18'	980	580	520
1501 C	3,192	57'	56'	18'	312	200	230
Lobby 1500	13,083	49'	267'	18'			
<b>LEVEL 2 - GRAND BALLROOM</b>							
2501 A, B, C, D	46,484						
2501 A,B,C	40,595	270'	150'	36'	3,900	2,000	3,000
2501 A	13,600	90'	150'	36'	1,300	700	900
2501 B	13,565	90'	150'	36'	1,300	700	900
2501 C	13,430	90'	150'	36'	1,300	700	900
Lobby 2501 D	5,889	49'	119'	36'			
Lobby 2500 A	9,917	29'	291'	18'			
Lobby 2500 B	17,043	45'	320'	20'			
2502 A,B	5,063	61'	83'	18'	588	352	320
2502 A	2,562	61'	42'	18'	270	154	140
2502 B	2,562	61'	42'	18'	270	154	140
2503 A,B	3,320	40'	83'	18'	400	226	230
2503 A	1,932	46'	42'	18'	180	98	90
2503 B	1,640	40'	41'	18'	144	84	110
2504 A,B	3,843	61'	63'	18'	405	231	210
2504 A	2,562	61'	42'	18'	270	154	140
2504 B	1,281	61'	21'	18'	135	77	70
2505 A,B	4,814	58'	83'	18'	615	373	370
2505 A	2,436	58'	42'	18'	252	140	140
2505 B	2,665	65'	41'	18'	288	168	160
<b>LEVEL 3 - GREAT HALL</b>							
3501 A,B,C,D,E,F,G,H	23,910	96'	206'	28'	2,250	1,545	1,650
3501 A,B,C,D	8,513	96'	83'	28'	950	510	580
3501 E,F,G,H	10,042	116'	83'	28'	1,178	630	700
3501 A	1,804	44'	41'	28'	162	98	80
3501 B	1,848	44'	42'	28'	162	98	80
3501 C	2,419	59'	41'	28'	252	154	140
3501 D	2,184	52'	42'	28'	216	140	110
3501 E	1,804	44'	41'	28'	162	98	80
3501 F	1,848	44'	42'	28'	162	98	80
3501 G	2,911	71'	41'	28'	324	196	140
3501 H	3,234	77'	42'	28'	360	224	190
Lobby 3500	11,760	42'	280'	28'			

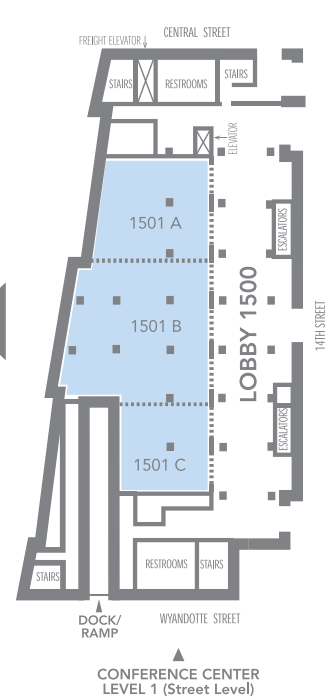
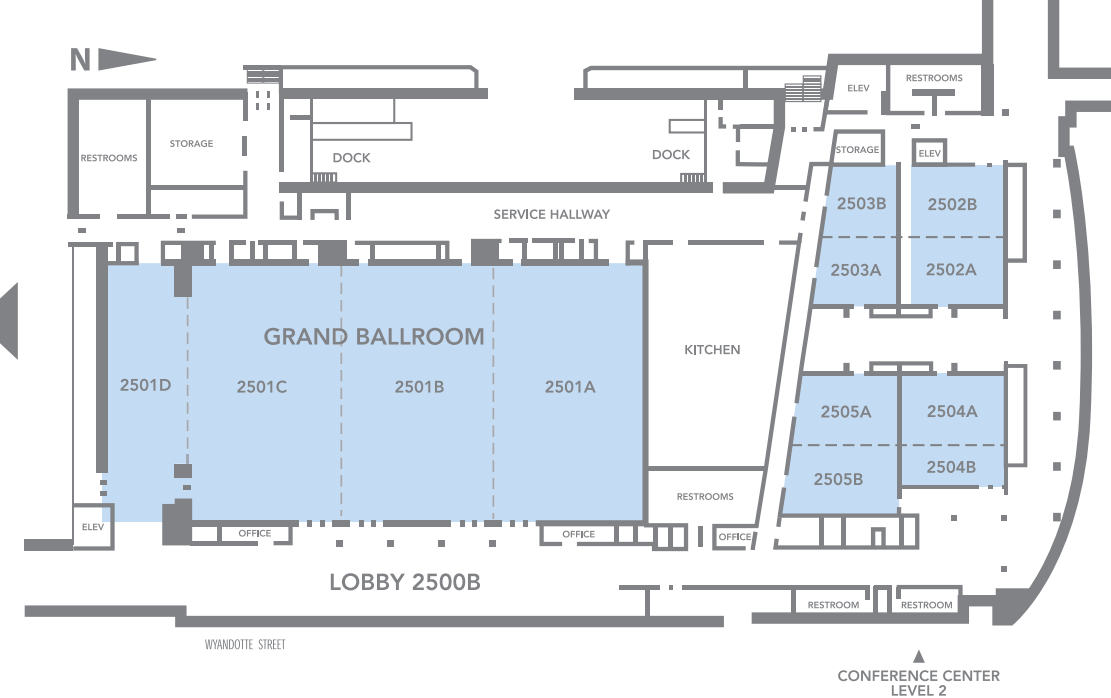

### 1501 DOCK/RAMP

- 14'6" W x 12' L
- Freight Elevator Interior 8'2" W x 12'9" L x 10' H
- Freight Elevator Door 5'5" W x 8' H

### BALLROOM DOCK (north)

- Automatic Roll-up Dock Door - 10' W x 10' H
- Three Truck Bays
- One Single Passenger Door

### BALLROOM DOCK (south)

- Automatic Roll-up Dock Door - 14'1" W x 10' H
- Three Truck Bays
- One Double Passenger Door
- Drive Up Ramp into Facility

Note that square footage is based on shortest width in irregularly-shaped rooms. There are passenger doors in the portable walls on all floors. Measurements are to the nearest foot.

