

# KANSAS CITY CONVENTION CENTER





---

## MEET ONCE, FRIENDS FOR LIFE.

---

With a creative energy all its own, Kansas City is anything but business as usual. It's a convention destination where friendly people, affordable prices and a central location are a given. Where creativity can be found around every corner. A place with a spirited personality and a genuine heart that's a breath of fresh air. We'd like you to meet Kansas City. To friends, it's just KC.

---

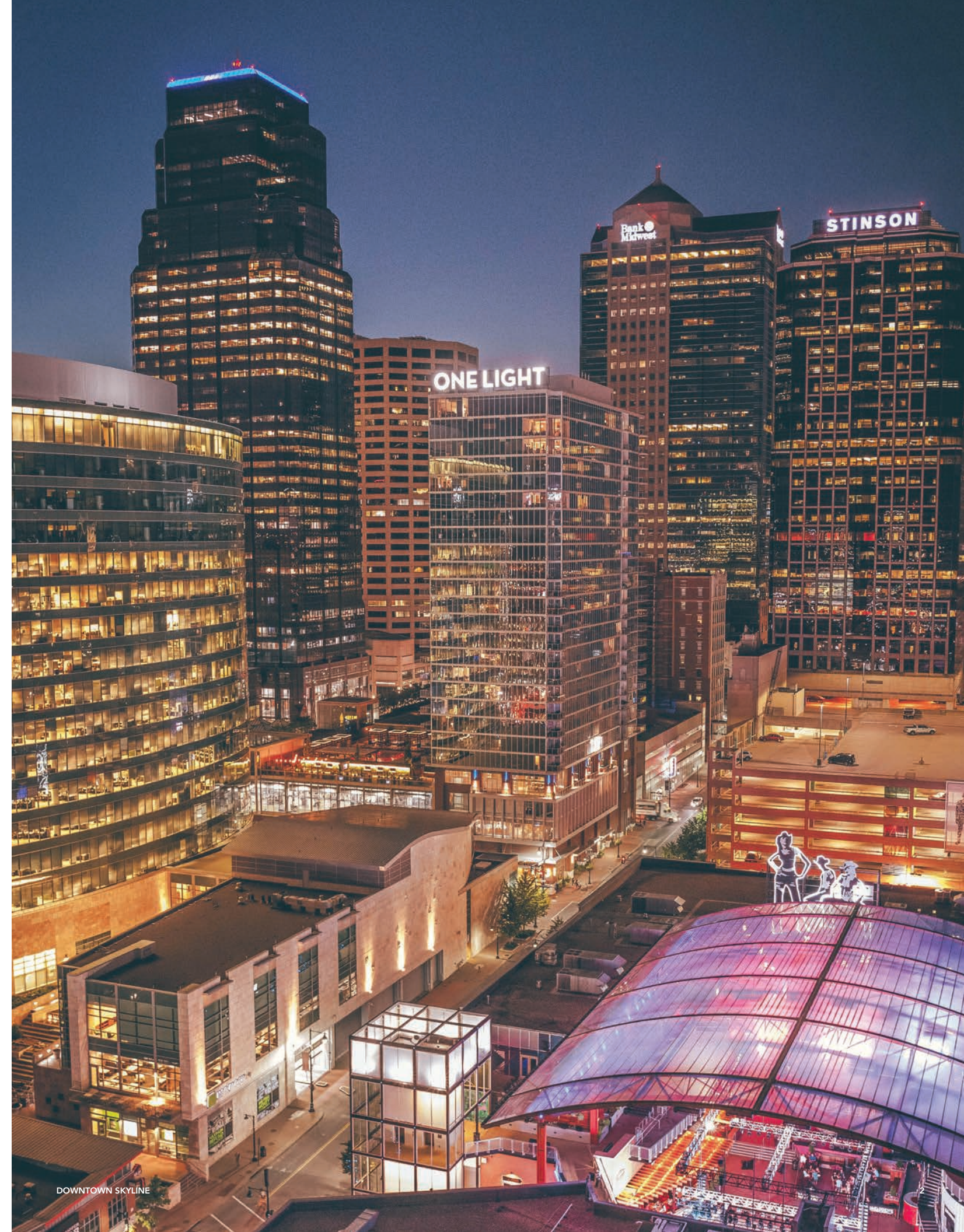

DOWNTOWN SKYLINE





“All the makings of an ideal urban destination.”  
– AFAR

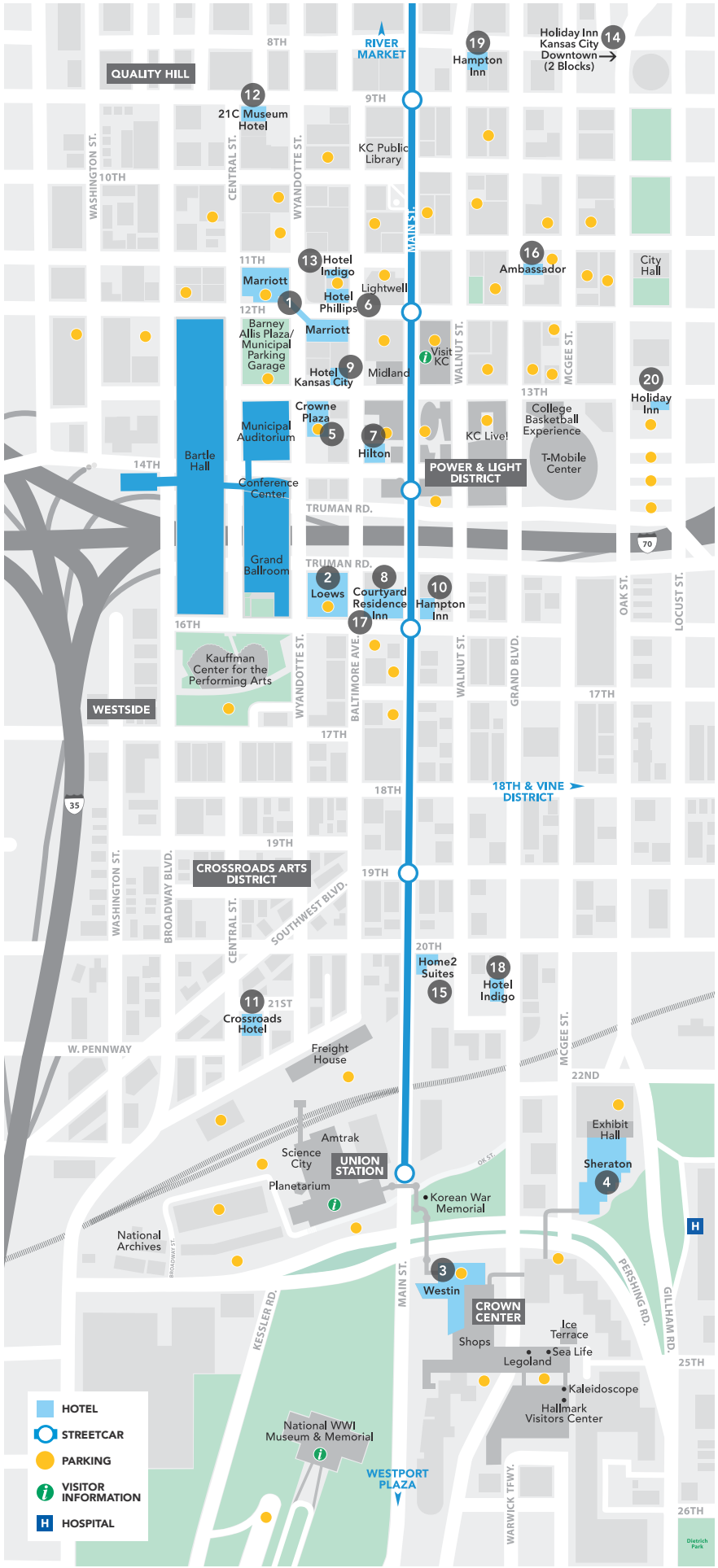

CONVENTION CENTER COMPLEX

- Bartle Hall
- Municipal Auditorium/Music Hall
- Conference Center
- Grand Ballroom
- Barney Allis Plaza/Municipal Parking Garage

HOTELS

- 1) Marriott Downtown - 970 Rooms
- 2) Loews Kansas City Hotel - 800 Rooms
- 3) Westin Crown Center - 724 Rooms
- 4) Sheraton Crown Center - 720 Rooms
- 5) Crowne Plaza - 385 Rooms
- 6) Hotel Phillips - 216 Rooms
- 7) Hilton President - 213 Rooms
- 8) Courtyard Downtown - 153 Rooms
- 9) Hotel Kansas City - 144 Rooms
- 10) Hampton Inn Crossroads - 132 Rooms
- 11) Crossroads Hotel - 131 Rooms
- 12) 21c Museum Hotel - 120 Rooms
- 13) Hotel Indigo Downtown - 118 Rooms
- 14) Holiday Inn Kansas City Downtown - 115 Rooms
- 15) Hilton Home2 Suites - 115 Rooms
- 16) Ambassador Hotel - 113 Rooms
- 17) Residence Inn Downtown - 108 Rooms
- 18) Hotel Indigo Crossroads - 81 Rooms
- 19) Hampton Inn Downtown - 74 Rooms
- 20) Holiday Inn Express - 73 Rooms

DINING & ENTERTAINMENT

- River Market
- Kansas City Power & Light District
- T-Mobile Center
- Kauffman Center for the Performing Arts
- Crossroads Arts District
- Westside
- 18th & Vine Historic Jazz District
- Union Station/Science City
- Crown Center Shops & Restaurants
- National WWI Museum and Memorial





# KANSAS CITY CONVENTION CENTER

Encompassing more than **800,000 square feet**, the Kansas City Convention & Entertainment Facilities can serve all your meeting needs under one roof. The eight-square-block convention and special event facility can accommodate **388,800 square feet** of column-free exhibit space on one floor; 48 state-of-the-art meeting rooms; a 2,400-seat fine arts theater; an arena that seats more than 10,700 people and a unique outdoor festival plaza.

And not only is it all in one location, the complex is connected to major downtown hotels and parking by skywalks and underground walkways. One of America’s largest green ballrooms—the 46,484-square-foot Grand Ballroom—is certified LEED silver, boasting waterless plumbing, energy-efficient heating & cooling and one of the most sophisticated lighting systems in the world. That’s enough to make other cities turn green with envy.

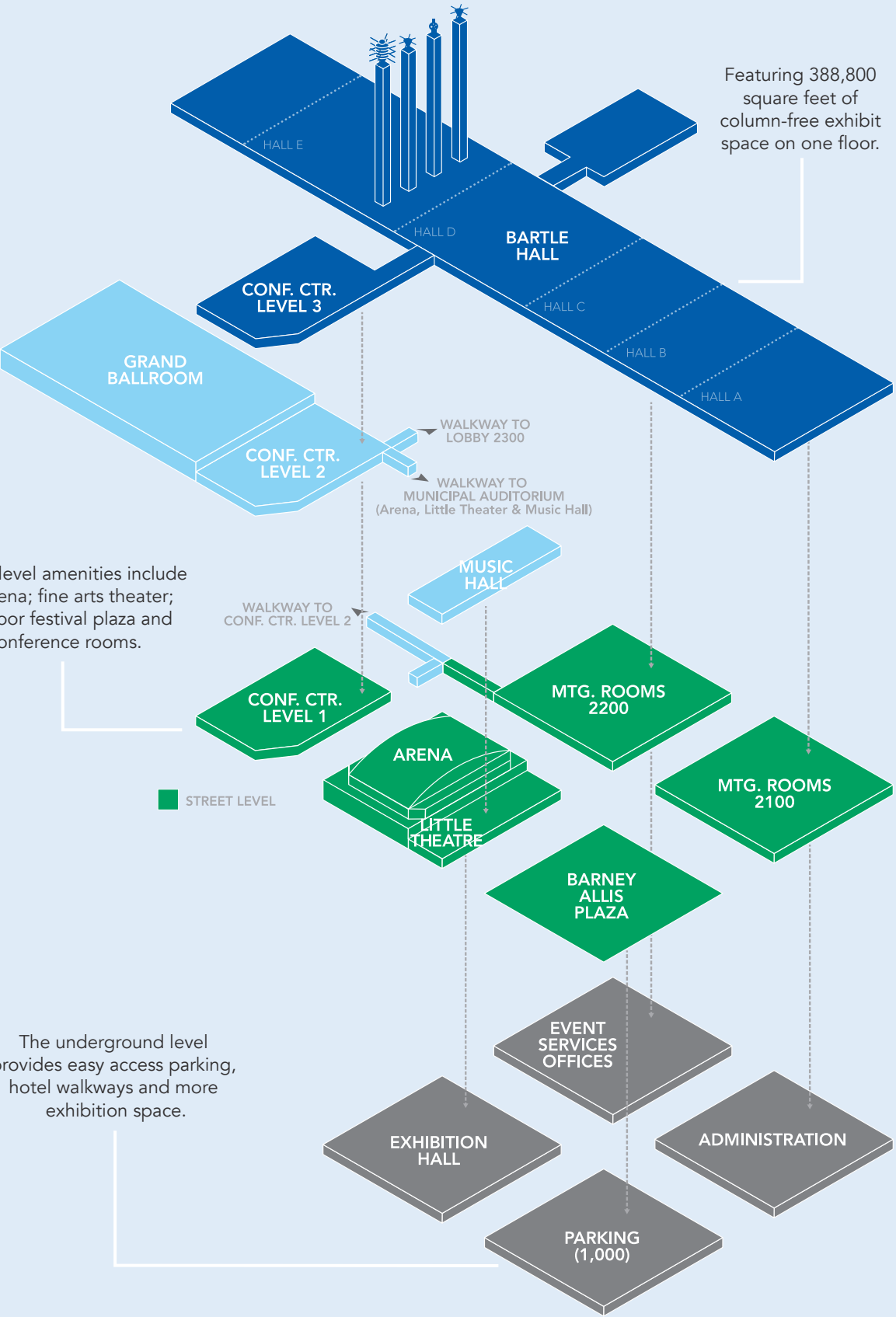
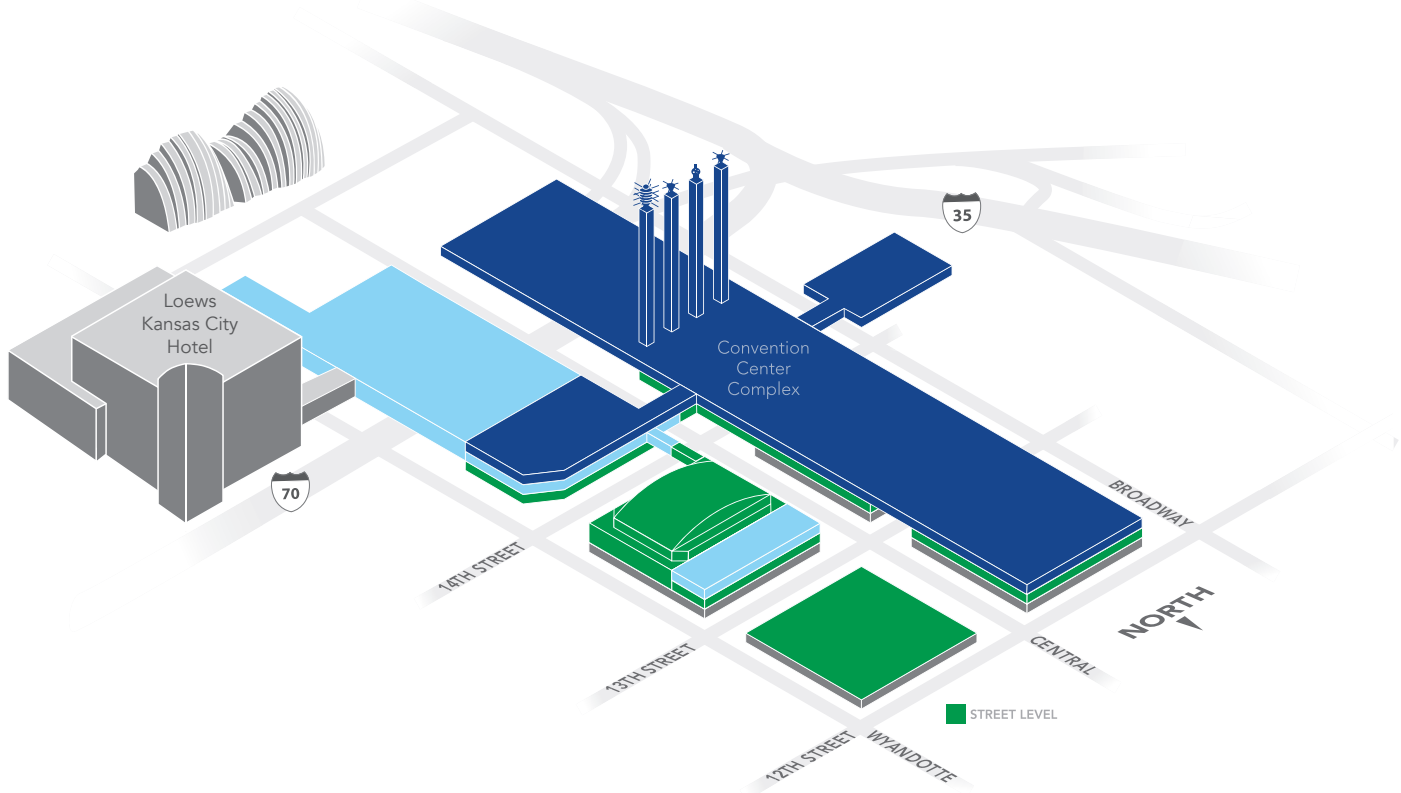



BARTLE HALL LEVEL 3

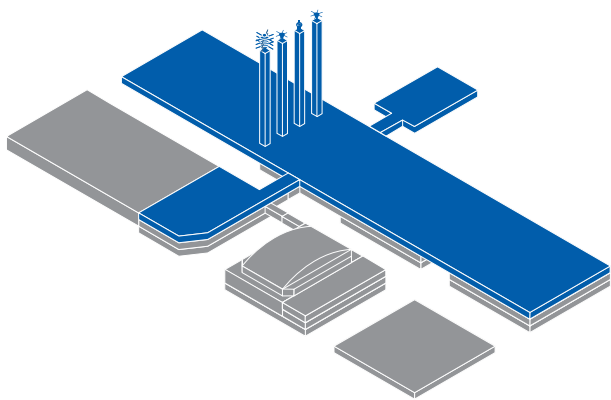

An exhibition hall the size of eight football fields

EXHIBIT HALL

- The hall’s 388,800 square feet of contiguous, column-free space allows for more than 2,000 10-by-10 foot booths.
- Four sound-resistant, movable walls can divide the Exhibit Hall into as many as five separate rooms.
- Utility floor ports on 30-foot centers include electrical, telephone and high speed Internet service. Some also include water, gas, air and drains.
- Amenities include high-blower air conditioning, LED lighting with 100 foot-candles and an electronic public address system.
- 300 lb./sq.ft. live floor load.

NOTES:



VIEW OF BARTLE HALL FROM LOEWS KANSAS CITY HOTEL

LOADING DOCKS

- North - 5 bays
- South - 12 bays
- West - 5 bays

DRIVE THROUGH DOORS

- North - 3-29’ W x 17’8” H
- South - 2-26’ W x 17’8” H
- West - 1-15’ 6” W x 17’8” H

HALL NAME	HALL DIMENSIONS				HALL CAPACITIES		
	SQ. FEET	WIDTH	LENGTH	CEILING HEIGHT	THEATER	BANQUET	10x10 BOOTHS
Hall A	68,850	270’	255’	33’	6,000	4,000	329
Hall B*	48,600	270’	180’	33’	4,000	3,000	265
Hall C*	76,950	270’	285’	33’	7,300	4,200	366
Halls A & B	117,450	270’	435’	33’	12,000	8,150	594
Halls A, B & C	194,400	270’	720’	33’	19,300	12,350	960
Halls D	93, 420	270’	346’	42’	9,600	5,400	448
Halls E	100,980	270’	374’	42’	10,000	5,700	483
Halls D & E	194,400	270’	720’	42’	19,620	11,100	931
Halls A, B, C, D	287,820	270’	1,066’	33’/42’	28,000	16,250	1,520
Halls A, B, C, D & E	388,800	270’	1,440’	33’/42’	38,000	22,000	2,066
Lobby 2400 <small>Not Shown</small>	14,500						

\*Halls B & C must be used with Hall A or D for access. Measurements are to the nearest foot.

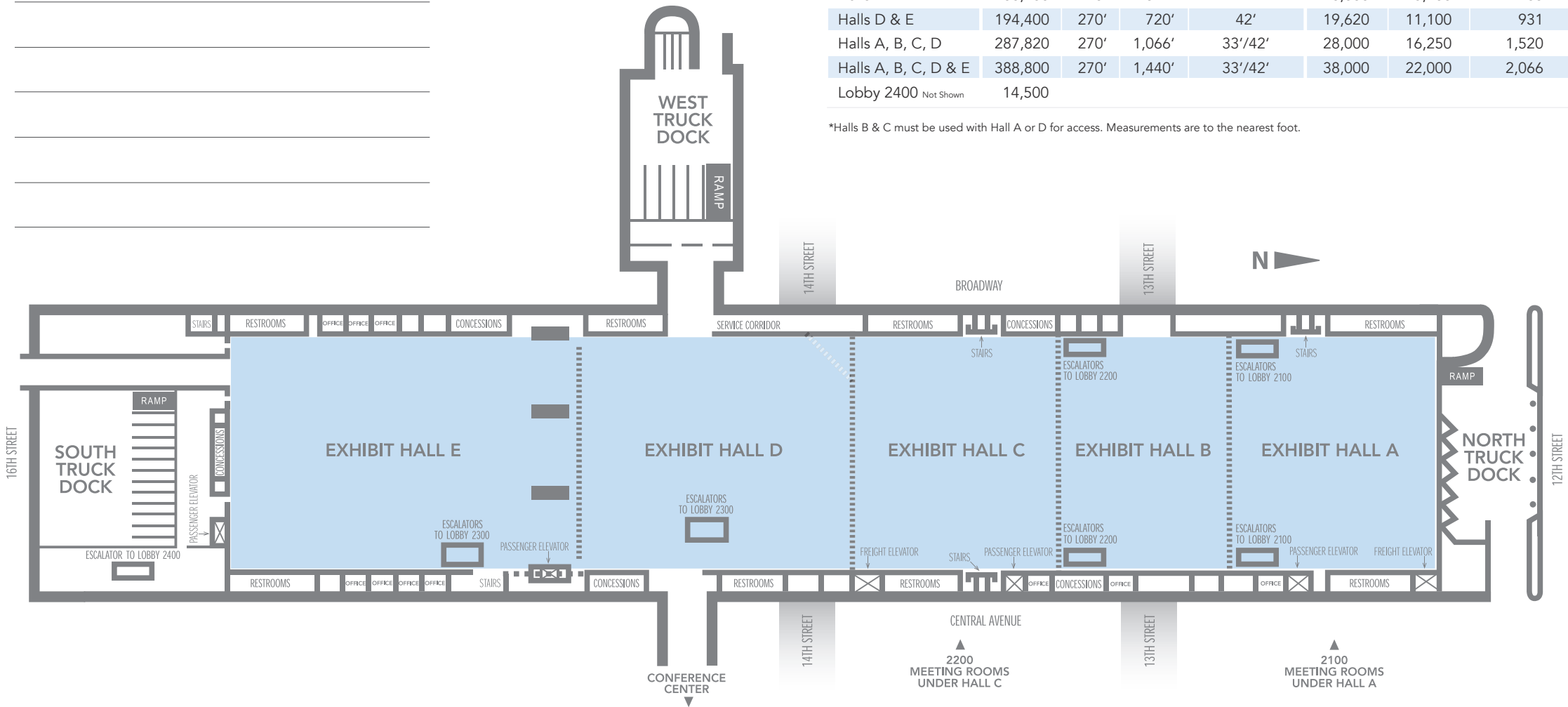



BARTLE HALL LEVEL 2

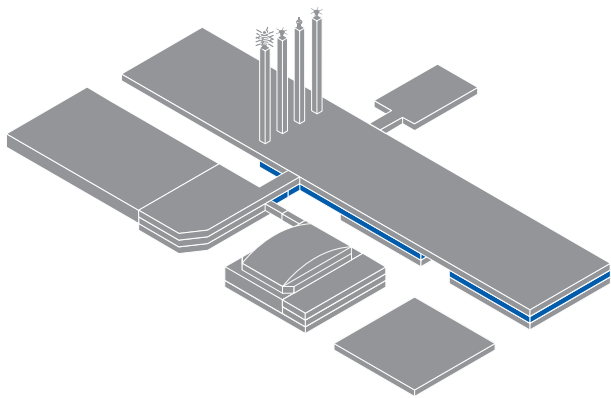

“Top 25 Future-Ready Cities”  
–Convene

MEETING ROOMS 2100 & 2200

- 26 meeting rooms encompass more than 62,000 square feet and accommodate more than 6,000 people.
- All rooms are equipped with individual sound systems, high-speed wireless Internet access, simultaneous taping, carpeting and a programmable lighting system that allows for individual control over each light unit.
- Specially-designed board and conference rooms offer built-in credenzas and data-powered A/V equipment.
- Ballroom 2103 features 18,096 square feet; 17-foot ceilings and is divisible into three breakout rooms.
- Ballroom 2103 comfortably seats 1,800 for general sessions and 1,250 for banquets.
- Three separate lobbies provide more than 53,500 square feet of versatile registration and pre-function space featuring a state-of-the-art projection system.
- Multiple banks of escalators, passenger and freight elevators provide easy access to all levels of the facility.

NOTES:

ROOM NAME	ROOM DIMENSIONS				ROOM CAPACITIES		
	SQ. FEET	WIDTH	LENGTH	CEILING	THEATER	CLASSROOM	BANQUET
2101	4,104	57'	72'	15'5"	420	220	300
2102 A,B	5,016	88'	57'	15'5"	500	270	360
2102 A	2,508	44'	57'	15'5"	250	135	180
2102 B	2,508	44'	57'	15'5"	250	135	180
BALLROOM 2103 A,B,C	18,096	87'	208'	17'10"	1,800	1,030	1,250
2103 A,B	10,266	87'	118'	17'10"	1,040	554	750
2103 A	5,133	87'	59'	17'10"	520	276	375
2103 B	5,133	87'	59'	17'10"	520	278	375
2103 C	5,133	87'	59'	17'10"	520	276	375
2104 A,B	5,016	88'	57'	15'5"	500	270	360
2104 A	2,508	44'	57'	15'5"	250	135	180
2104 B	2,508	44'	57'	15'5"	250	135	180
2105	4,104	57'	72'	15'5"	420	220	300
LOBBY 2100 Services Hall A	8,340						
2201	1,344	28'	48'	10'	132	96	80
2202	1,344	28'	48'	15'7"	132	96	80
2203	1,344	28'	48'	15'7"	132	96	80
2204	1,344	28'	48'	15'7"	132	96	80
2205	1,344	28'	48'	15'7"	132	96	80
2206	1,344	28'	48'	15'7"	132	96	80
2207	1,344	28'	48'	10'	132	96	80
2208	1,344	28'	48'	15'7"	132	96	80
2209	1,344	28'	48'	15'7"	132	96	80
2210	1,344	28'	48'	15'7"	132	96	80
2211	1,344	28'	48'	15'7"	132	96	80
2212 Boardroom	588	21'	28'	9'10"	NA	NA	14
2213 Boardroom	588	21'	28'	9'10"	NA	NA	14
2214	1,344	28'	49'	15'7"	132	96	80
2215 A,B,C	8,176	56'	146'	16'5"	820	430	580
2215 A	3,248	56'	58'	16'5"	320	170	230
2215 B	1,624	56'	29'	16'5"	160	85	116
2215 C	3,248	56'	58'	16'5"	320	170	230
LOBBY 2200 Services Hall B	22,500						
LOBBY 2300 Services Hall D&E	23,000						

Measurements are to the nearest foot.

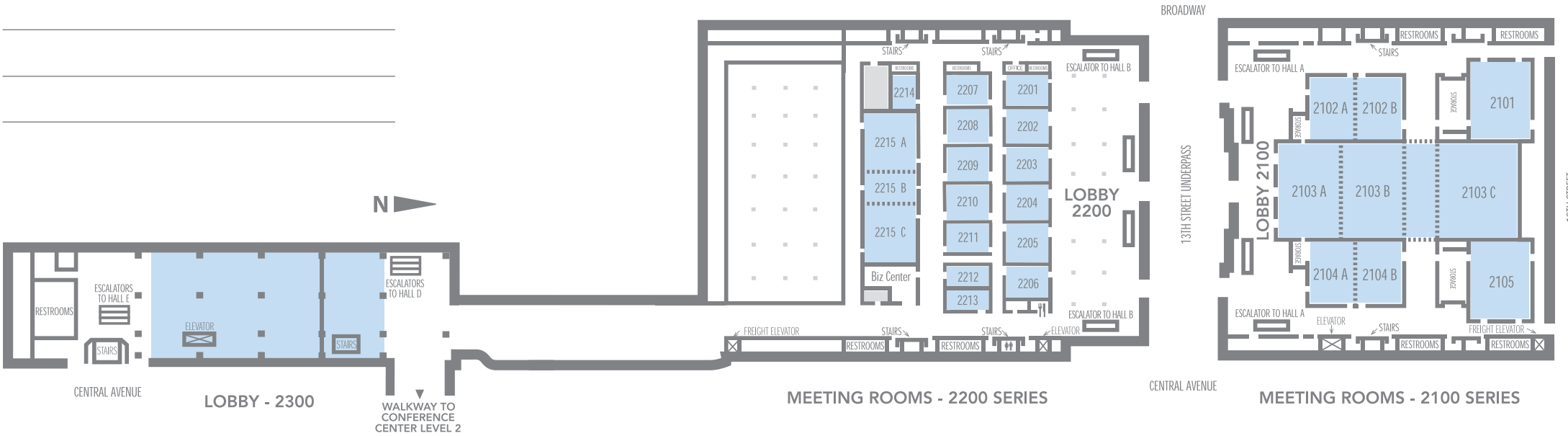

With more than **62,000 square feet** of meeting space divided among 26 rooms, Bartle Hall Level 2 offers you the convenience and versatility that today’s meetings demand. The space recently completed a total remodel to add state-of-the-art amenities and high-end finishes to complement any event. Choose from a wide variety of room sizes, each featuring high-speed wireless Internet access and professional sound and lighting systems. Each room is designed to give you maximum set-up flexibility, as well as easy accessibility for attendees.





CONFERENCE CENTER & GRAND BALLROOM

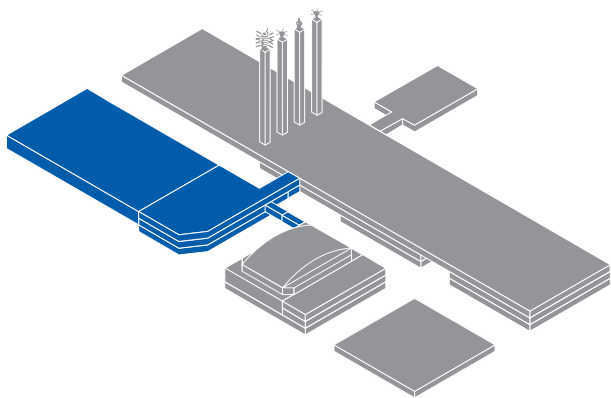

The complex’s 100+ WiFi access points ensure you are always connected.

CONFERENCE CENTER

- More than 56,000 total square feet on three levels, seating up to 6,000.
- Space is divisible to up to 19 rooms featuring high-speed Internet connectivity, sound-proof dividing walls, state-of-the-art sound system, variable lighting, individual temperature controls and centralized taping capabilities.
- Features 34,760 square feet of elegant registration or pre-function space that is divisible for up to three offices or breakout rooms to support registration area.
- Barrier free movement with conveniently located escalators, passenger and freight elevators.

GREAT HALL (3501)

- Features 23,910 square feet, 28-foot ceilings and is divisible into eight breakout rooms.
- Comfortably seats 2,250 for general session and 1,650 for banquets.
- Connects via skywalks directly to the exhibit floor level of Bartle Hall and Municipal Auditorium.



GRAND BALLROOM ENTRANCE

GRAND BALLROOM (2501)

- One of the nation’s largest eco-friendly ballrooms at 46,484 square feet.
- Features dramatic views to the south of the Performing Arts Center via a 38-foot-high glass wall.
- Divisible into three separate rooms that can be operated independently for greater meeting flexibility.
- Offers a unique, controllable day-lighting system to allow natural light in the space that changes as the sun moves.
- Opens to an outdoor plaza at the southeast corner of the Convention Center complex.
- Connects to the existing Conference Center to accommodate additional breakout rooms.
- Connects to the new Loews hotel via enlosed walkway.

ROOM NAME	ROOM DIMENSIONS				ROOM CAPACITIES		
	SQ. FEET	WIDTH	LENGTH	CEILING	THEATER	CLASSROOM	BANQUET
LEVEL 1							
1501 A,B,C columns	14,904	72'	207'	18'	1,708	1,049	1,140
1501 A	3,752	67'	56'	18'	416	269	280
1501 B	7,238	77'	94'	18'	980	580	520
1501 C	3,192	57'	56'	18'	312	200	230
Lobby 1500	13,083	49'	267'	18'			
LEVEL 2 - GRAND BALLROOM							
2501 A, B, C, D	46,484						
2501 A,B,C	40,595	270'	150'	36'	3,900	2,000	3,000
2501 A	13,600	90'	150'	36'	1,300	700	900
2501 B	13,565	90'	150'	36'	1,300	700	900
2501 C	13,430	90'	150'	36'	1,300	700	900
Lobby 2501 D	5,889	49'	119'	36'			
Lobby 2500 A	9,917	29'	291'	18'			
Lobby 2500 B	17,043	45'	320'	20'			
2502 A,B	5,063	61'	83'	18'	588	352	320
2502 A	2,562	61'	42'	18'	270	154	140
2502 B	2,562	61'	42'	18'	270	154	140
2503 A,B	3,320	40'	83'	18'	400	226	230
2503 A	1,932	46'	42'	18'	180	98	110
2503 B	1,640	40'	41'	18'	144	84	90
2504 A,B	3,843	61'	63'	18'	405	231	210
2504 A	2,562	61'	42'	18'	270	154	140
2504 B	1,281	61'	21'	18'	135	77	70
2505 A,B	4,814	58'	83'	18'	615	373	370
2505 A	2,436	58'	42'	18'	252	140	140
2505 B	2,665	65'	41'	18'	288	168	160
LEVEL 3 - GREAT HALL							
3501 A,B,C,D,E,F,G,H	23,910	96'	206'	28'	2,250	1,545	1,650
3501 A,B,C,D	8,513	96'	83'	28'	950	510	580
3501 E,F,G,H	10,042	116'	83'	28'	1,178	630	700
3501 A	1,804	44'	41'	28'	162	98	80
3501 B	1,848	44'	42'	28'	162	98	80
3501 C	2,419	59'	41'	28'	252	154	140
3501 D	2,184	52'	42'	28'	216	140	110
3501 E	1,804	44'	41'	28'	162	98	80
3501 F	1,848	44'	42'	28'	162	98	80
3501 G	2,911	71'	41'	28'	324	196	140
3501 H	3,234	77'	42'	28'	360	224	190
Lobby 3500	11,760	42'	280'	28'			

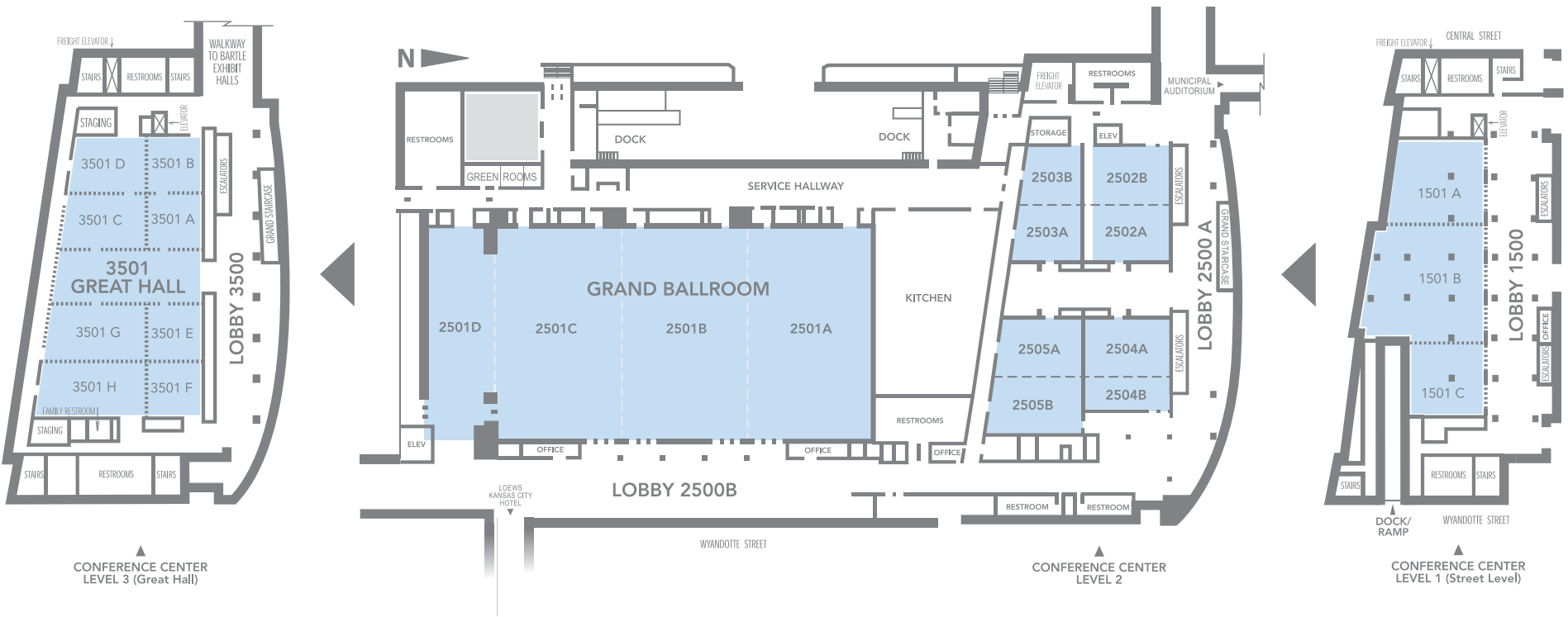

1501 DOCK/RAMP

- 14'6" W x 12' L
- Freight Elevator Interior 8'2" W x 12'9" L x 10' H
- Freight Elevator Door 5'5" W x 8' H

BALLROOM DOCK (north)

- Automatic Roll-up Dock Door - 10' W x 10' H
- Three Truck Bays
- One Single Passenger Door

BALLROOM DOCK (south)

- Automatic Roll-up Dock Door - 14'1" W x 10' H
- Three Truck Bays
- One Double Passenger Door
- Drive Up Ramp into Facility

Note that square footage is based on shortest width in irregularly-shaped rooms. There are passenger doors in the portable walls on all floors. Measurements are to the nearest foot.



GRAND BALLROOM OUTDOOR PLAZA



MUNICIPAL AUDITORIUM

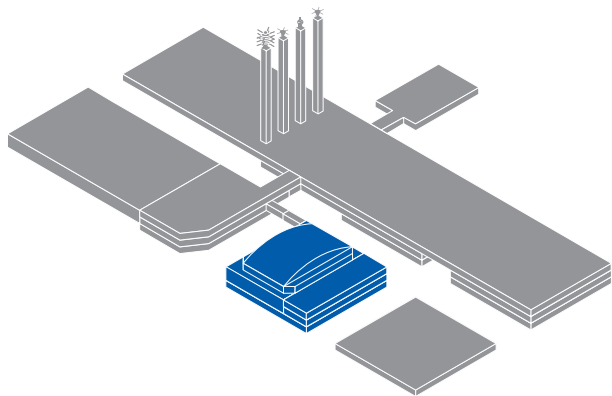

Kansas City's Art Deco Municipal Auditorium complex includes three unique and versatile special event and banquet venues. The Arena seats **10,404**; the Music Hall, one of the nation's finest theaters, seats **2,403**; and the Little Theatre is perfect for more intimate events. Municipal Auditorium connects directly to Level 2 of the Conference Center, to the underground parking garage and downtown hotel walkway system.

“On the heels of \$9 billion worth of investment, Kansas City has a new story to tell.”  
—Prevue Meetings

LOWER EXHIBITION HALL (The LEX)

- 46,000 square feet of additional space on two levels for exhibitors, catered functions or special events.
- The Hall has its own entrance lobby off 14th Street, is accessible to all parts of Municipal Auditorium and has direct access from the Barney Allis Garage.

MUNICIPAL ARENA

- 7,312 permanent seats; 2,084 seats on risers plus capacity for 1,008 theater-style on main floor.
- Upholstered seating, two large video boards and a sports-lighting system.
- Public amenities include fully-lighted marquee; large box office; 3,600-square-foot foyer; coat check; multiple restrooms and concession stands.
- Heavy all-wooden floor.
- Ramps and elevators facilitate movement of freight throughout the building.

LITTLE THEATRE (ARENA LEVEL)

- Octagon shaped in a gleaming marble façade, the Little Theatre features an exterior promenade, balcony and a permanent stage area.
- With temporary theater seating for up to 400 people and banquet seating for 225, the Little Theatre is perfect for executive dinner parties and intimate special events.

MUSIC HALL

- Opened in 1936, this unique Art Deco theater is the perfect facility for special convention presentations, general sessions or featured entertainment.
- A totally self-contained venue, the Music Hall has its own lighted marquee, box office, main entrance, coat check, restrooms and concessions.
- Total seating capacity is 2,403; with Orchestra seating for 1,207; Loge and Box seating for 278; and Balcony seating for 918.
- Features a spectacular 3,600-square-foot foyer and grand staircase.
- The Music Hall's Art Deco lighting fixtures are the inspiration for the Sky Stations atop Bartle Hall's four pylons.

NOTES:



LOWER EXHIBITION HALL

ROOM NAME	ROOM DIMENSIONS				ROOM CAPACITIES		
	SQ. FEET	WIDTH	LENGTH	CEILING	THEATER	CLASSROOM	BANQUET
ARENA	27,000	133'	204'	92'	10,404	904	1,008
LITTLE THEATRE	5,329	73'	73'	19'	564	175	225
Permanent Stage	—	10'	21'6"	12'	—	—	—
MUSIC HALL	—	—	—	60'	2,403		
Permanent Stage	—	80'	54"	46'	—	—	—
Freight Elevator	—	8'6"	27'6"	8'11"		12,000 lbs.	
EXHIBITION HALL	28,000	114'	195'	23'	1,400	800	900
Mezzanine Level	18,000	38'	195'	10'	—	—	—

Measurements are to the nearest foot. Capacities in Exhibition Hall represent area between columns.

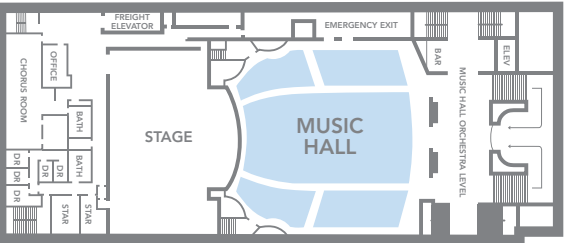
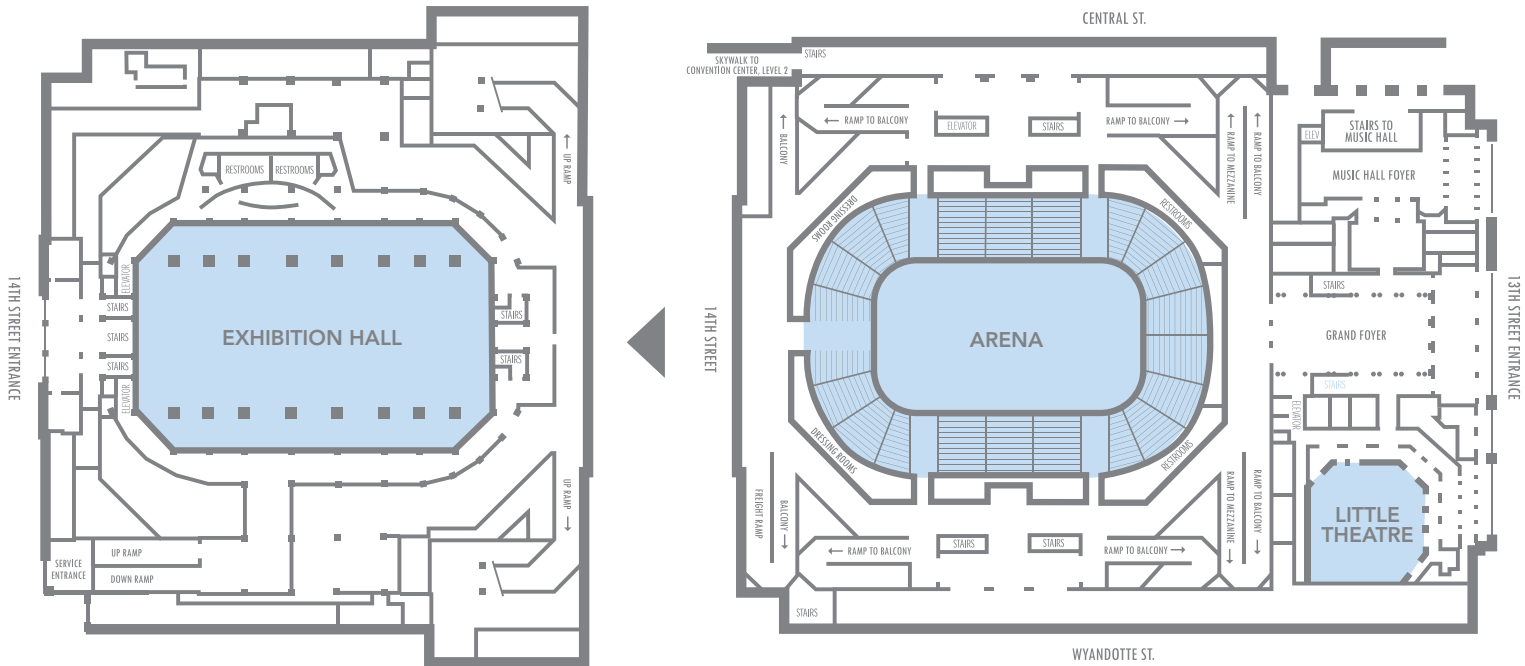

MUSIC HALL







For more information about planning  
a meeting in Kansas City, please call:

**VISIT KC**

1475 Walnut St., Ste. 202  
Kansas City, MO 64106  
816-691-3800 • **877-528-4748**

**VISITKC.COM/MEETINGS**

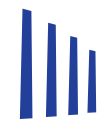

KANSAS CITY  
CONVENTION  
CENTER

For more information about the Kansas City  
Convention Center, please call:

**Kansas City Convention and  
Entertainment Facilities**

301 West 13th St., Suite 100  
Kansas City, MO 64105  
816-513-5000 • 800-821-7060

**KCCConvention.com**

Cover photo: Grand Ballroom

